



Harvester 1058_{H5}



Join the family





Gremo 1058H5 is a harvester that makes the thinning of the forest more efficient, more profitable, and at the same time gentler on the terrain.

The new engine is a step V without EGR valve. This means that the entire exhaust purification now takes place in a single unit - a Single Module - where catalyst, particle filter, and urea are collected in one after-treatment system alone. The new solution without EGR valve takes half as much space as before, resulting in greatly reduced installation dimensions.

Another major virtue is the new lateral cooling devices on 1058H5. This results in a lower noise level in the cabin, while the visibility backwards becomes better.

The crane has also become larger and considerably more powerful with a higher lifting torque. The crane size means increased capacity and a far more flexible harvester head than ever before. One of our options is the active bogie that enables extreme passability in very steep terrain.

Overall, the low fuel consumption makes the 1058H5 a harvester that provides better economy and lower footprint in the environment.





The engine is a step V without EGR valve. The after-treatment of the exhaust gases is done in a Single Module. It takes up less space, resulting in significantly decreased installation dimensions.



The large and long way downwards reaching windows offer excellent visibility. You can see the wheels without having to lean out. The selection of the trees can be carried out without any greater effort, and the narrow pillars offer perfect visibility during the processing.



The cooling devices are positioned on the side instead of arranged in the front of the cabin and behind it. This results in a lower noise level in the cabin, while your visibility backwards becomes better.



The active bogie is one of our options. It enables extreme passability in very steep terrain.





The crane holder provides a low center of gravity, while enabling very good visibility in the work area.



Eight wheels and well balanced weight distribution will ease your way even under tough conditions on rough terrain.



Two different reach lengths are available. The operator sits close to the crane and can easily follow the way of the harvester head between the trees up to full reach length. This means less damage on the trunks and shorter crane cycles.

Technical data

Engine

Engine	Cummins B6,7 200 6-cylinder Stage V.
Capacity (liters)	6,7
Torque (Nm) at rpm	990/1300
Power output kW (HP) at rpm	149/(200)
Cooling system	Laterally mounted with automatic reversing fan.
Fuel tanks	345L
Other	Electronically adjustable constant-speeds automatically actuated.

Transmission/Steering/Brakes

Tractive force (kN)	14
Hydrostatic drive	Variable transmission by GreControl. Tank separated from the working hydraulics.
Gearbox	2-steps gearbox. Gear 1: 0-9,2 km/h. Gear 2: 0-25 km/h. (0-20km DE)
Gearwheel bogies	Cast iron, roller path bearing.
Differential locks	Separately controlled with 100 % locking.
Hub reduction	On every wheel.
Steering system	Servo-steering. Electrical proportional terrain steering in separate lever.
Steering torque (kNm)	Off-road steering 41/Orbitrol 49
Steering angle (°)	+/- 43
Brakes	4 oil-immersed multiple-disc brakes in front and rear differentials. Parking and emergency brake actuating all multiple-disc brakes and actuated automatically in neutral.
Other	Foot pedals for forward/backward and driving speed. Warning system with fault indication in plain text and acoustic/optical signal.

Hydraulics

Working hydraulics	Constant pressure/load sensing system.
Pump (cc)	175 Variable
Flow (l/m)	Variable adjustable in GreControl (216-280)
Working pressure (MPa)	240
Other	Tanks with electrical re-filling device via filter. Hydraulic fan controlled by GreControl with automatic reversing for the cooling devices of hydrostat and hydraulics.

Crane/Crane Control

Crane	Mesera 221H
Reach (m)	10
Gross lifting torque (kNm)	188kNm
Crane control	GreControl 6 operator selecting alternatives.

Electrics

Voltage (V)	24
Generator (A)	175
Battery (Ah)	2x145
Working lights LED	18
Other	Travel lights according to law.

Harvester Head/Mesuring

Type	SP 561 LF with maximum root pruning 60 cm
Delimiting diameter (cm)	43 tip-tip
Roller motors (cc)	560 alt. 625
Measuring system	DASA Forester with large touch screen and keyboard. Canbus communication.
Other	Automatic chain tensioner SC 100, Auto cut, LogHold, QuickCut, proportional pressure on pruning knives and feed rollers. Adjusted by Dasa4.

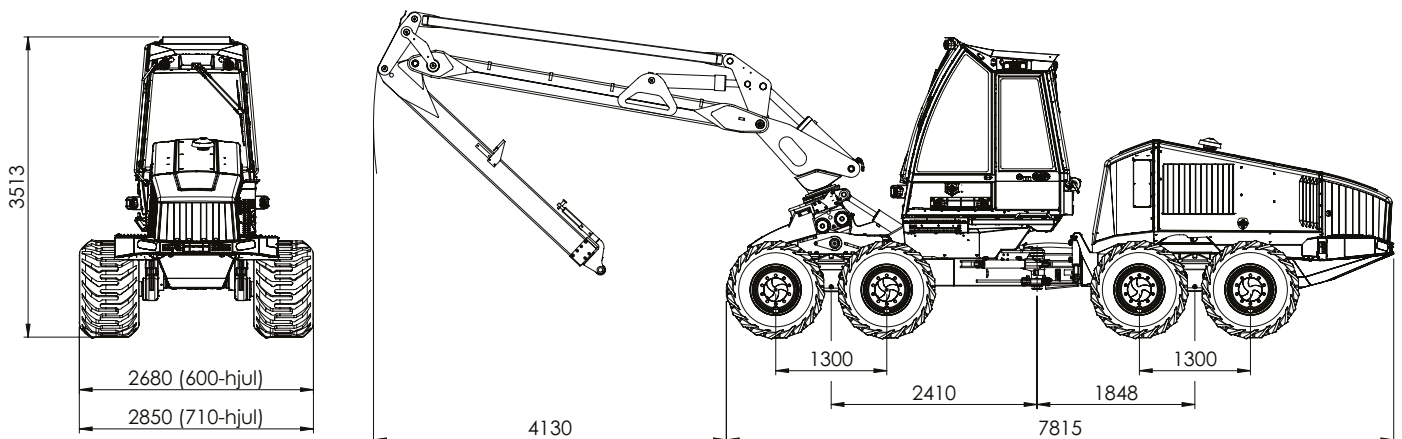

Weight with basic equipment: 15 900 kg.

Equipment

Vehicle, standard

- Mesera 221H, 10 m
- SP 561 LF
- Pneumatic compressor
- Wheels 710/40x22,5
- Vehicle drive, engaging and disengaging control
- Bogielift with separate operation of righthand and lefthand bogies
- Middle joint and bogie locks on all bogies with automatic actuation
- Diesel heater
- Water separating fine filtration for working hydraulics
- Vacuum pump
- Hydraulic ladder
- Reversing fans
- 2 tools compartment front
- Sprinkler equipment, 2 hand extinguishers
- LED lights, 18 in total
- Air hose reel
- 24V socket at fuel tank
- Two hooks front and rear
- Transport equipment (LGF plate, lightning, rear mirror)

Cabin standard

- Electronic Climate Control
- Opening side window (emergency exit)
- Safety glass panes
- Sun blinds, upper part towards the crane, 1/3
- Interval screen wiper with parallel guide front and rear, one-wipe impulse button
- 12V and 24V sockets in instrument pane
- Wheel control
- Radio/CD, 2 loudspeakers, Bluetooth
- Air-chushioned, electrically heated drivers seat, safety belt, neckrest
- Electrically-braked seat rotation
- Mini levers
- Rear mirror
- Sun blind at front
- Prepared for telephone incl. aerial
- Cruise control
- 6 off adjustable driver´s programme
- GreControll machine control with, for instance, distance meter, service alarm, trouble shooting

Options

- Mesera 221H 11 m
- Automatic levelling of tilting movement
- Gremo active bogie
- Indexator slewing damper MPD single/double
- Bogie lift with independent control of left/right sides
- Lighting of parallel rod
- Data caliper
- GPS navigation
- Side screen wipers
- View camera engine part
- Wear irons for bogie cases
- Seat tilting
- Seat ventilated
- Seat, side and lumbar cushions electric/air adjusted
- 5-button mini levers
- Sun curtains
- Stump treatment 130 liter
- Tool kits, 4 extra
- Tool kit Gremo, 65 parts
- Liquid-filled tyres
- Bogie tracks/anti-skid chains

Options harvester head

- SP 461 LF root pruning 53 cm
- Colour marking
- Multi-tree handling
- Alt. Feed rolls

WORLD CLASS FORESTRY MACHINES

We work with probably the most valuable assets in this world: Forest and people. Our challenge is to make you feel comfortable working with our machines, but also to develop, build and sell forestry machines apt to cause as little harm to the forest as possible

without renouncing efficiency and performance. We are well on the way. No less than 95% of our customers buy a Gremo machine again. Are you possibly one of those who have missed something?

Gremo AB · Box 44 · SE-311 51 Ätran
Phone: +46 (0)346 605 15 · web site: www.gremo.com · E-mail: info@gremo.se

We reserve the right to change specifications and design. Machines shown may have some extra equipment.
All specified measurements / values are approximative data and refer to standard-equipped machines.